

MODEL M-25 DIAGRAM

PRIMARY CABINET DIMENSIONS

SPECIFICATIONS (CENTIMETERS ARE REPRESENTED BY [])

MAX WEIGHT CAPACITY : 130 lbs [59 kg]
 MAX TRAVEL (EXTENSION) : 27 in [65.6 cm]
 LIFT SYSTEM HEIGHT: 22.5 in [57.2 cm]
 MAX DISPLAY HEIGHT : 22.25" in [56.5 cm] MINUS LID THICKNESS

QUICK REFERENCE DIMENSION GUIDE (USE WHICHEVER IS GREATER)

DISPLAY DIMENSIONS : W____, H____, D____
 MIN. INTERIOR CABINET WIDTH : W+2 in [5.1 cm] = ____ OR 20.25 in [51.4 cm]
 MIN. LID CUTOUT WIDTH : _____
 MIN. INTERIOR CABINET HEIGHT : H+1 in [2.6 cm] = ____ OR 22.75 in [57.8 cm]
 MIN. INTERIOR CABINET DEPTH : D+3.625 in [9.2 cm] = ____ OR 5.375 in [13.7 cm]
 MIN. LID CUTOUT DEPTH : _____

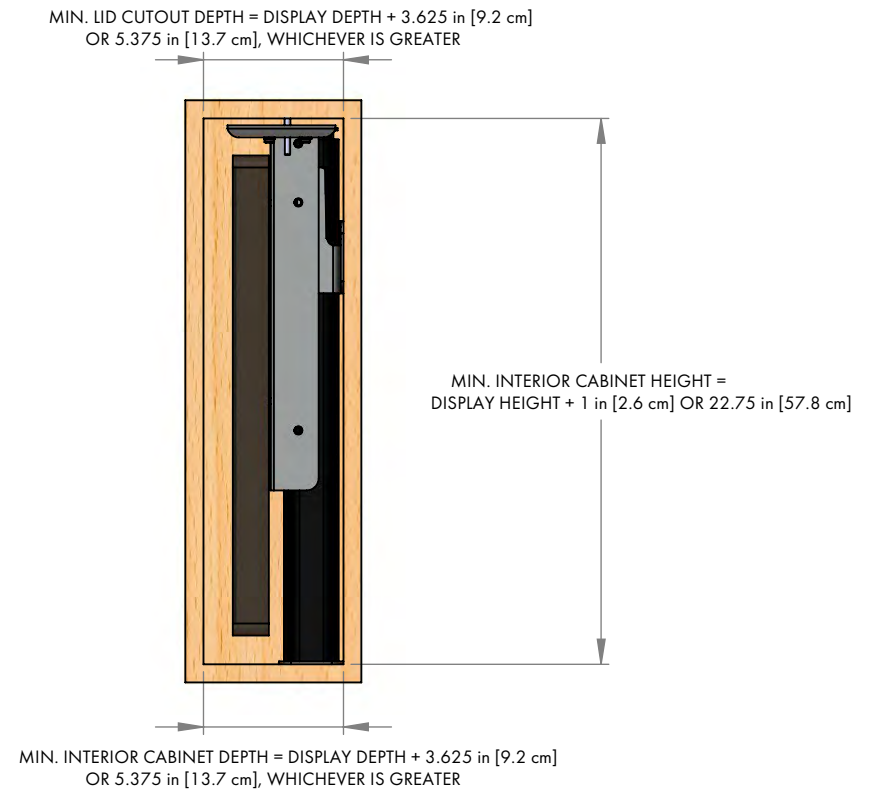
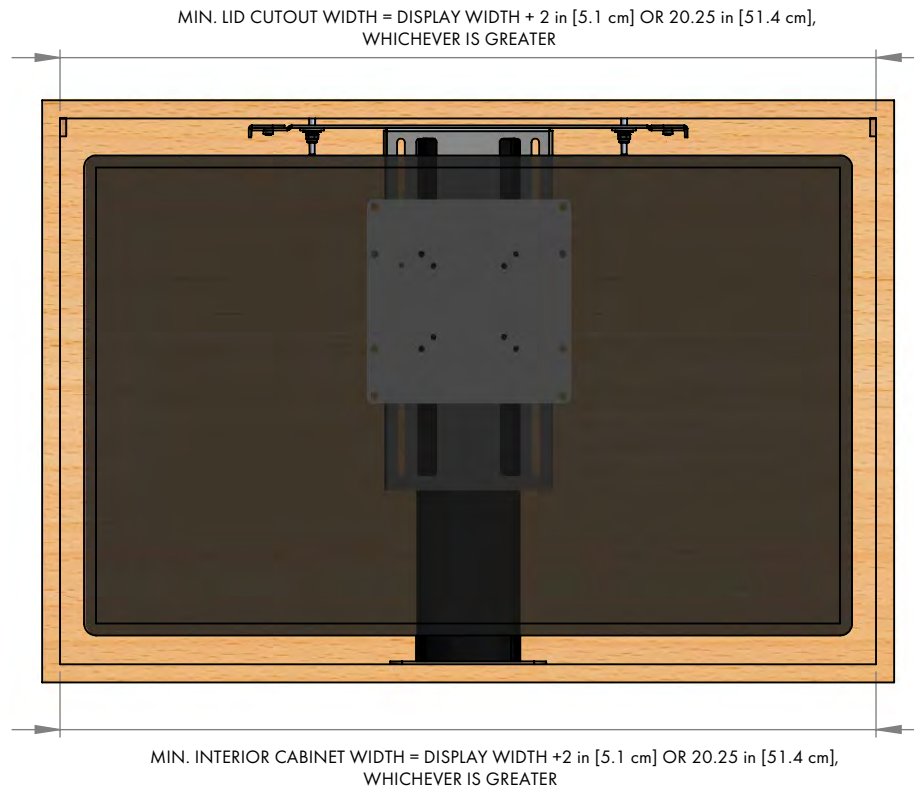

NOTES:

1. THE CABINET BOX SHOWN IN THE DIAGRAM IS FOR REFERENCE ONLY AND IS NOT PROVIDED WITH THE LIFT SYSTEM
2. WHEN DETERMINING DISPLAY HEIGHT, ALWAYS USE MANUFACTURER SUPPLIED "DISPLAY WITHOUT STAND" HEIGHT
3. LIFT MECHANISM IS POWDERCOATED BLACK STEEL, COLORS IN DIAGRAM ARE FOR CLARITY ONLY
4. THE HEIGHT OF THIS MODEL IS NOT ADJUSTABLE; A PLATFORM MUST BE USED TO INCREASE LIFT SYSTEM HEIGHT

NEXUS₂₁

COPYRIGHT 2023 - ALL RIGHTS RESERVED
 UPDATED 2/20/23

MODEL M-25 DIAGRAM

CABINET REFERENCE DIMENSIONS

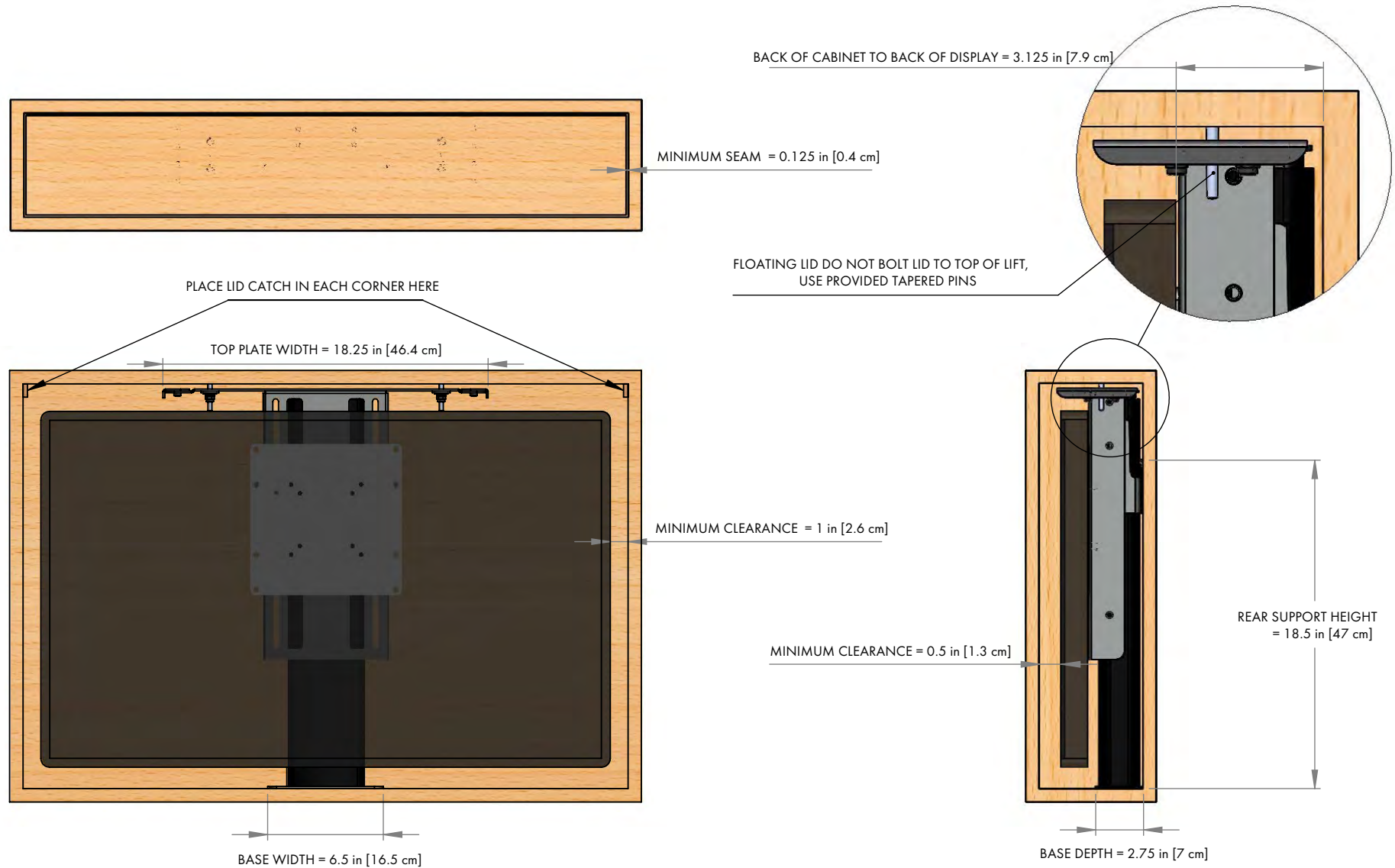

NOTES:

1. TAPERED PINS ALLOW LID TO FLOAT WITH THE USE OF THE LID CATCHES.
2. MINIMUM SEAM CAN BE REDUCED TO 0.0625 in [0.2 cm] WITH A 45 DEGREE BEVEL ON THE LID

NEXUS₂₁

COPYRIGHT 2023 - ALL RIGHTS RESERVED
UPDATED 2/20/23